

DIN 571 sim. UNI 704

Vite per legno a testa esagonale (tirafondo)

Hexagon head wood screw

Disponibile/Available :



A2



A4

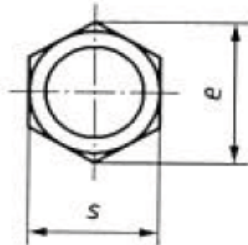
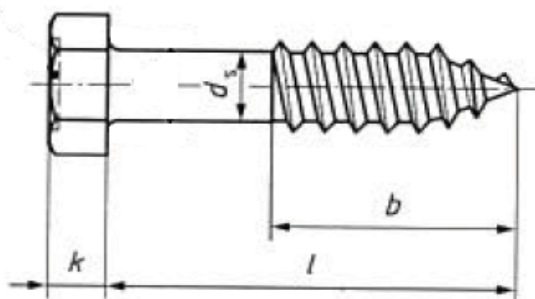

$$b \geq 0,6 l$$



Thread size		M4	M5	M6	(M7)	M8	M10	M12	M16	M20
d_s	max.	4,00	5,00	6,00	7,00	8,00	10,00	12,00	16,00	20,00
	min.	3,52	4,52	5,52	6,42	7,42	9,42	11,30	15,30	19,30
k	Nominal size	2,8	3,5	4	5	5,5	7	8	10	13
	max.	3,10	3,88	4,38	5,38	5,88	7,45	8,45	10,45	13,90
	min.	2,50	3,13	3,63	4,63	5,13	6,55	7,55	9,55	12,10
s	Nominal size	7	8	10	12	13	17	19	24	30
	max.	7,00	8,00	10,00	12,00	13,00	17,00	19,00	24,00	30,00
	min.	6,64	7,64	9,64	11,57	12,57	16,57	18,48	23,16	29,16
e	min.	7,50	8,63	10,89	13,07	14,2	18,72	20,88	26,17	32,95

Evitare le misure tra parentesi se possibile.

Bracketed sizes should be avoided if possible.

Le misure commerciali sono quelle tra le due linee in grassetto (pag.2/2)

The commercial sizes are those given in the zone between the stepped lines (pag. 2/2)

PAG. 1/2

last edit 09/08/2019

DRAWING N. 1104

/	max.	min.	M4	M5	M6	(M7)	M8	M10	M12	M16	M20
16	15,10	16,90	4X16	5X16							
20	18,95	21,05	4X20	5X20	6X20						
25	23,95	26,05	4X25	5X25	6X25	7X25	8X25				
30	28,95	31,05	4X30	5X30	6X30	7X30	8X30	10X30			
35	33,75	36,25	4X35	5X35	6X35	7X35	8X35	10X35	12X35		
40	38,75	41,25	4X40	5X40	6X40	7X40	8X40	10X40	12X40		
45	43,75	46,25		5X45	6X45	7X45	8X45	10X45	12X45		
50	48,75	51,25		5X50	6X50	7X50	8X50	10X50	12X50	16X50	
55	53,50	56,50		5X60	6X55	7X55	8X55	10X55	12X55	16X55	
60	58,50	61,50		5X70	6X60	7X60	8X60	10X60	12X60	16X60	20X60
65	63,50	66,50			6X65	7X65	8X65	10X65	12X65	16X65	20X65
70	68,50	71,50			6X70	7X70	8X70	10X70	12X70	16X70	20X70
75	73,50	76,50			6X75	7X75	8X75	10X75	12X75	16X75	20X75
80	78,50	81,50			6X80	7X80	8X80	10X80	12X80	16X80	20X80
90	88,25	91,75			6X90	7X90	8X90	10X90	12X90	16X90	20X90
100	98,25	101,75			6X100	7X100	8X100	10X100	12X100	16X100	20X100
110	108,25	111,75			6X110	7X110	8X110	10X110	12X110	16X110	20X110
120	118,25	121,75			6X120	7X120	8X120	10X120	12X120	16X120	20X120
130	128,00	132,00			6X130	7X130	8X130	10X130	12X130	16X130	20X130
140	138,00	142,00			6X140	7X140	8X140	10X140	12X140	16X140	20X140
150	148,00	152,00				7X150	8X150	10X150	12X150	16X150	20X150
160	158,00	162,00					8X160	10X160	12X160	16X160	20X160
170	168,00	172,00					8X170	10X170	12X170	16X170	20X170
180	178,00	182,00					8X180	10X180	12X180	16X180	20X180
190	187,70	192,30					8X190	10X190	12X190	16X190	20X190
200	197,70	202,30					8X200	10X200	12X200	16X200	20X200
Le lunghezze eccedenti i 200 mm, sono classificate in incrementi di 20 mm									PAG. 2/2		last edit 09/08/2019
Lengths exceeding 200 mm shall be graded in 20 mm increments.									DRAWING N. 1104		